



BARTHOLOMEW & CO



3 Braeside Court BOONAH, QLD

 5  3  4  5996 m2

## The Perfect Property - with fresh internal paint!

Situated in a tidy small estate with large blocks taking in some lovely views is this immaculate 5 bedroom brick home on 5,996m<sup>2</sup>. Only a minutes drive to Boonah or even within walking distance to all amenities this property boasts many features such as:

- Freshly painted interior of house
- 3 bathrooms including 2 ensuites
- Large open plan living - dining - kitchen area
- Seperate rumpus room with options to suit your needs
- Media room
- 5 bedroom or 4 + office
- Large BBQ area
- Town water
- Large 16m x 7m colourbond shed - 3 bays lockable with a 2 bay carport
- Power to shed
- 2 garden sheds - 3mx3m and 3mx 2m

**Price:** \$590,000.00  
**Property Type:** Acreage/Semi-Rural

**Gordon Saunders**

0413008187

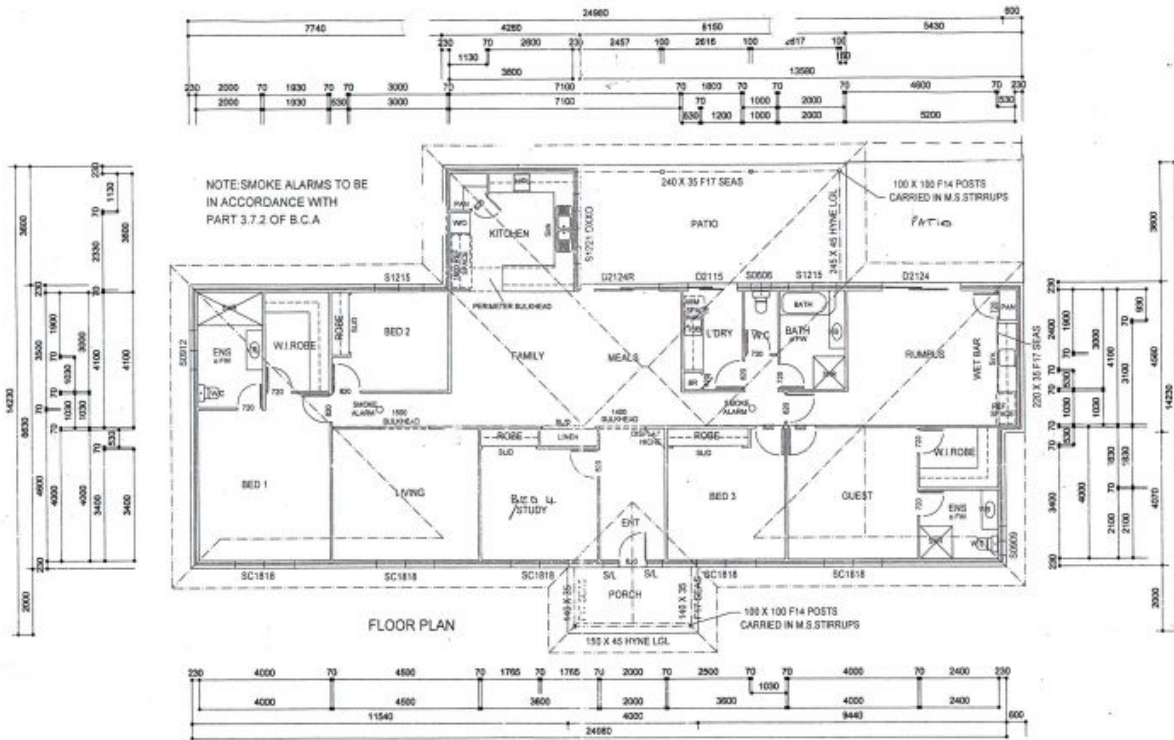

PROPOSED DWELLING

AT LOT — 16  
BRAESIDE CT  
BOONAH  
4310

FOR — [REDACTED]

LIVING AREA - 233.649 sq m

PORCH AREA - 8.030 sq m

PATIO AREA - 29.310 sq m

TOTAL AREA - 270.989 sq m

BUILDER TO VERIFY DIMENSIONS

DRAWN BY - W.H. WILSON — 3200 6836

Building Designer License No. 056987

SCALE 1:100

DATE — 06-08-2007

SHEET — 2 OF 8

DRAWING number — WH10330