



20 Park Street Boonah, QLD

3 2 2 812 m2

## Stunning Character Home

This is one not to miss! A beautiful character home located in central Boonah within walking distance to shops, cafes, restaurants, schools etc. The home is in pristine condition featuring 3 generous bedrooms, large ensuite to main as well as built in wardrobe and bay window. The main bathroom is very spacious and includes a bath and 2nd toilet. A light and airy living room flows from the eat-in kitchen that has stone bench tops, new dishwasher and air-con. The kitchen opens through bi-fold doors onto a huge rear verandah which makes for the perfect entertaining space. The home has features of the era with polished pine floor boards, high ceilings, vj walls, French doors and lovely front porch. The fully fenced 812m2 block has rear yard access and also houses a 6m x 7m shed complete with power connected. There is also 2 x 3,000L slim line poly tanks and a large 6.5kw solar system. There are lovely gardens, manicured lawn, cat enclosure and plenty of room for the kids to play or for someone to store a boat or caravan. A quality character home in tip top condition and only a stone's throw from Boonah town centre, 20 Park Street will be hard to beat. An inspection will not disappoint.

**Price:** \$699,000

**Property Type:** House

**Tony Moller**

0421215463

# 20 Park St, Boonah

3 | 2 | 2 | 191m<sup>2</sup>

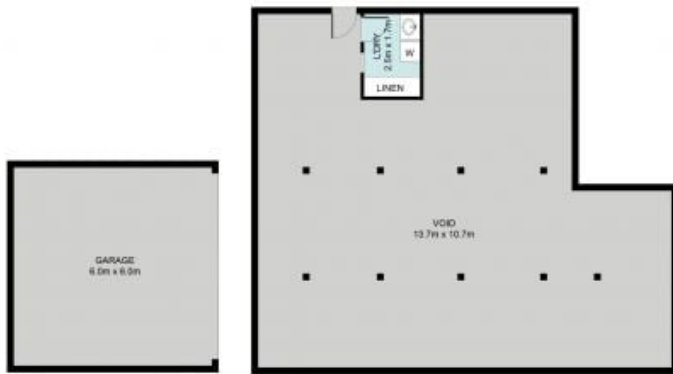

GROUND LEVEL



FIRST LEVEL

Whilst every attempt has been made to ensure the accuracy of the floor plan contained here, measurements of the doors, windows, rooms and any other items are approximate and no responsibility is taken for error, omission or mis-statement. This plan is for illustrative purposes only and should only be used as such by any prospective purchaser. The services systems and appliances shown have not been tested and no guarantee as to their operability or efficiency can be given.